

2025 CWM
AL-64 = PC / PS
AL-64-2 = NPL
AL-63 = RC

3064796

MAP# 9753
CHERYL BERKEN
BROWN COUNTY
REGISTER OF DEEDS
GREEN BAY, WI
RECORDED ON
05/28/2024 08:42 AM
REC FEE:
REC FEE: 30.00
PAGES: 3

CERTIFIED SURVEY MAP

BEING A PART OF PRIVATE CLAIMS 16 AND 17, EAST SIDE OF FOX RIVER, VILLAGE OF ALLOUEZ, BROWN COUNTY, WISCONSIN.

NOTE
SEE SHEET 3 FOR CURVE DATA TABLE.

BASIS OF BEARINGS
THE SOUTH LINE OF PRIVATE CLAIM 16, BEARS N 63°45'29"W AS REFERENCED TO THE BROWN CO. CRD. SYSTEM, NAD83 (2011).

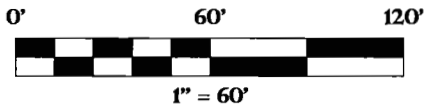

AL-64-2

OUTLOT 1
7,662 Sq. Feet ±
0.176 Acres ±
TO WATER'S EDGE
4,681 Sq. Feet
0.107 Acres
TO MEANDER LINE

20' WIDE
RECREATIONAL
TRAIL LEASE PER
DOC. NO. 1809500

FLOODWAY LINE
PER GIS SHAPE
FILES FROM
FEMA WEBSITE.

N 63°45'29" W
42' ±
DOC # 1795368
VARIES

N 28°40'54" E
21.00'
DOC # 2887630

LOT 2
11CSM165
BY OTHERS
DOC # 2873461

LOT 1
DOC # 2988970
P.C. 17

PUBLIC TRUST DOCTRINE
ANY LAND BELOW THE ORDINARY
HIGH WATERMARK OF A LAKE OR
NAVIGABLE STREAM IS SUBJECT TO
THE PUBLIC TRUST IN NAVIGABLE
WATERS THAT IS ESTABLISHED
UNDER ARTICLE IX, SECTION 1,
OF THE STATE CONSTITUTION.

LOT 1
N 62°21'03" W
(N 62°32'00" W)
DOC # 287506
PRIVATE CLAIM 16
PRIVATE CLAIM 17

S 63°45'29" E
18.00'
Flood Zone "AE" Line Per FEMA GIS
Shape From the FEMA Website.

UNABLE TO SET
CORNER DUE TO
LARGE BOULDER 2"
BELOW GROUND
SURFACE.

FOX RIVER STATE TRAIL
C3

DOC # 1795368
DOC # 2887630

MEANDER LINE
20' ±
187.40' ±
17.00' ±

RIVER
S 63°38'44" E
37' ±
S 63°38'44" E
66.04' ±
33' ±

AL-64

LOT 1
61,076 Sq. Feet
1.402 Acres
DOC # 2687630

POS BY PLS #1030
DATED: 1989

NOTE
THIS MAP DOES NOT
TRANSFER PROPERTY
OWNERSHIP. SALE OR
TRANSFER OF PROPERTY
REQUIRES A RECORDED
DEED, EXCEPTING PUBLIC
DEDICATIONS.

LEGEND
● 3/4" X 18" IRON REBAR SET
WEIGHING 1.50 LBS/LIN. FT.
○ 1-1/4" O.D. IRON PIPE FOUND
● 3/4" IRON REBAR FOUND
▲ MAG NAIL FOUND
☒ CHISELED "X" FOUND
() RECORDED AS

UNPLATTED
LANDS
S 63°38'44" E
246.05'
DOC # 2741117
BY OTHERS

RIVERSIDE DRIVE
247.19'
N 27°38'57" W
216.65'
S 27°38'57" W
45'
R/W VARIES
CORNER #30FG 20-21
CORNER #30E/F-20/21
CORNER #30F/G 20/21(2)

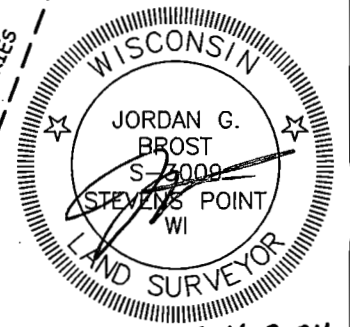

CLIENT / OWNER
FOX TRAIL
DEVELOPMENT, LLC
2100 RIVERSIDE DRIVE
GREEN BAY, WI 54301
SHEET 1 OF 3

FIELDWORK COMPLETED: 12/19/23
DRAWN: TDP CHECKED: JGB
FIELD BOOK: 88 PAGE: 27
JOB NO: 23.135

Land Surveying
Civil Engineering
Landscape Architecture
Jordan G. Brost, PLS #3009
4941 Kirschling Court
Stevens Point, WI 54481
715.344.9999 (PH) 715.344.9922 (FX)

Point of Beginning