

2025 CWM  
E-413-2 = PS  
E-413-3 = NPL  
E-413-4 = NPL

3072954

MAP# 9796  
CHERYL BERKEN  
BROWN COUNTY  
REGISTER OF DEEDS  
GREEN BAY, WI  
RECORDED ON  
08/29/2024 09:28 AM  
REC FEE:  
REC FEE: 30.00  
PAGES: 3

CERTIFIED SURVEY MAP

PART OF THE SW-SW, SECTION 31, T. 23 N.- R. 22 E.,  
TOWN OF EATON, BROWN COUNTY, WISCONSIN

Legend

- ⊙ 1" iron pipe found
  - 1" X 18" iron pipe (set) min. wt. 1.13 lb./lin.ft.
- Bearings referenced to the southerly line of the  
SW 1/4 assumed N 89°55'06" W

Tax # E-413-2

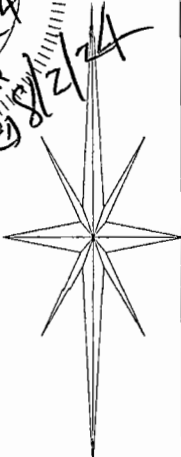
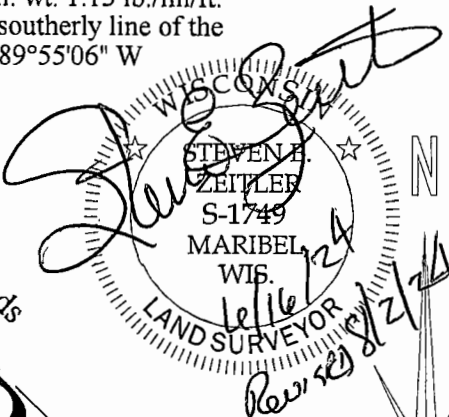

CTH "R"

E-413-2

Lot 1

Area

315,541 sq.ft.

7.244 Ac.

RESTRICTIVE COVENANT

"The construction of structures which rely upon onsite sewerage disposal systems for sanitary waste disposal shall be prohibited on Lot 1 until all state, county, and municipal regulations have been met and a sanitary permit has been issued by the Brown County Zoning Administrator's Office."

Lot 2

Area

65,340 sq.ft.

1.50 Ac.

E-413-3

Lot 3

Area

65,340 sq.ft.

1.50 Ac.

E-413-4

Pine Grove

unplatted lands  
Graphic Scale

Road

Lot 1

22CSM146